

### Installing NVMe M.2 Solid State Drive

- 1) As a precaution, ensure that you backup all your data prior to doing any type of work on your computer system.
- 2) Power on your PC and access the motherboard BIOS (refer to your owner's manual on how to do so)
- 3) Once you have access the BIOS, make sure that the PCIe device is set in the BIOS boot sequence or boot priority list.
  - a. Reference your motherboard owner's manual or system owner's manual for information regarding the boot sequence and detecting boot devices, for booting from an M.2 device.
  - b. Some motherboard requires the NVMe storage device option to be enabled prior to installation.
- 4) Make sure you save the BIOS settings and exit.
- 5) Power down your computer.
- 6) Locate the M.2 slot on your motherboard. (Please reference your owner's manual for detailed location and orientation of the M.2 slot)

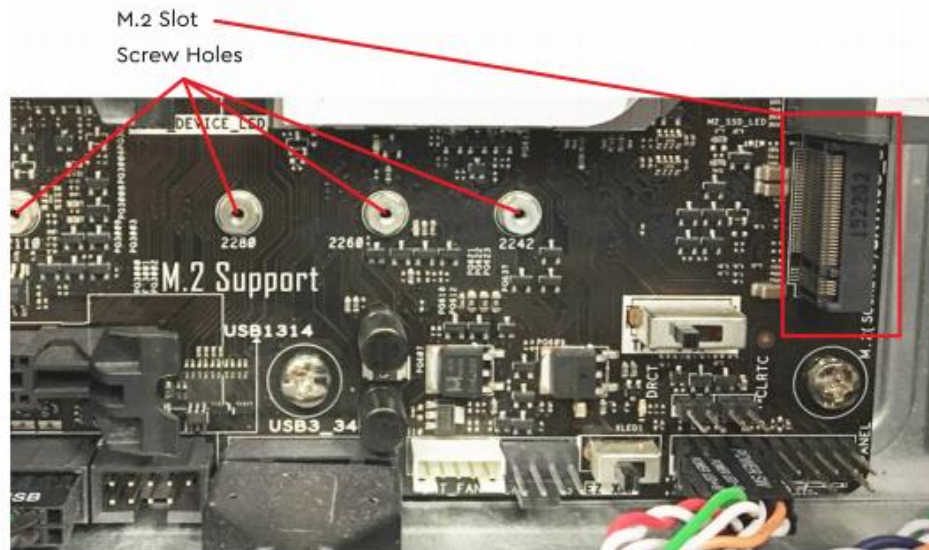

Example of a Motherboard M.2 Mounting Setup

7) Insert the PCIe SSD M.2 device pin-side first into the M.2 slot as is illustrated below.

**Insert the M.2 device at an angle**

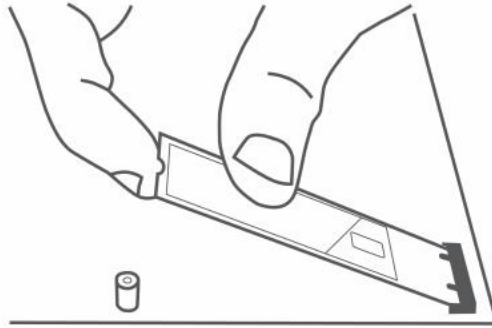

8) Fasten the opposite end of the M.2 to the motherboard with the necessary screw or hardware.

**Fasten screw to opposite end of the M.2**

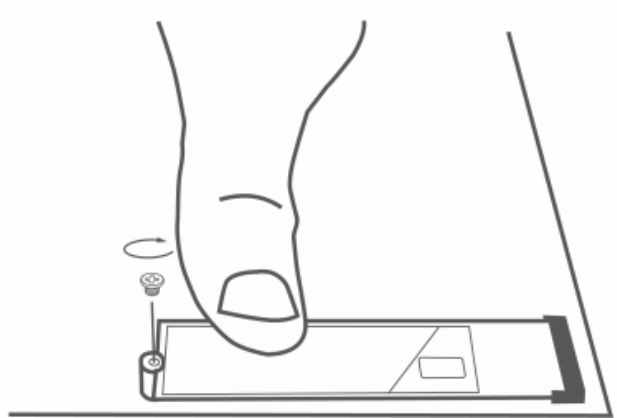

- 9) Being your operating system installation from a USB device or CD/DVD rom.
- Microsoft Windows 8.1 or Microsoft Windows 10 is recommended for proper PCIe / M.2 boot and installation support.
  - Microsoft Windows 7 installation on NVMe devices that use the PCIe bus requires a hotfix. Use this Microsoft KB article for assistance: [KB 2990941](https://support.microsoft.com/kb/2990941)

## **Customer Service and Technical Support**

For technical support, customer server or returns, contact us using your preferred method below.

**Toll Free:** 1-855-888-8685

**International:** 1-626-435-9102

**Email:** [support@blackdiamondmemory.com](mailto:support@blackdiamondmemory.com)